

3.6 MM (K TYPE)

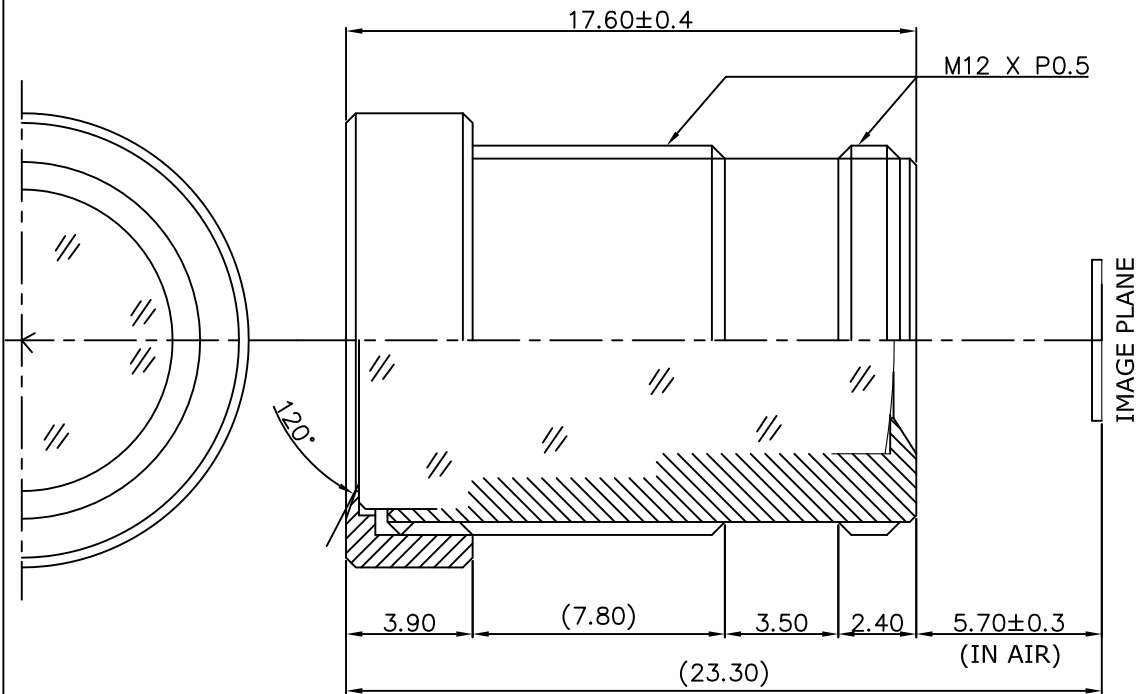

1. SENSING AREA : IMX122 [SONY 1/2.9"CMOS]
1/3"[6mm(D) x 4.8mm(H) x 3.6mm(V)]
2. FOCAL LENGTH : $3.6\text{MM} \pm 5\%$
3. BACK FOCAL LENGTH : $6.4\text{MM} \pm 5\%$ (IN AIR)
4. MAXIMUM RELATIVE APERTURE : $2.0 \pm 5\%$
5. IRIS : FIXED
6. LENS CONSTRUCTION : 4 COMPONENTS 4 ELEMENTS
7. ANGULAR FIELD OF VIEW :

	IMX122	1/3"
DIAGONAL	120.0°	105.8°
HORIZONTAL	92.6°	80.0°
VERTICAL	54.6°	58.0°
8. FUNCTION : IR-Correction Lens
(IT IS CHANGEABLE ON EXTERNAL DIMENSION
BY CUSTOMER'S REQUIREMENT.)

			TOLERANCES	Designed		Title	f=3.6MM Fno 2.0 IR-CORRECTION Lens	
			ANGLE 1°/2	Checked				
			X. ± 0.2	Approved				
			.X ± 0.1 .XX ± 0.05					
A4	Scale	N/S		Dwg No.		DATE	2014.04.11	REVISION NO. -00